



PROGRAMME
OF EVENTS

RENDEZ-VOUS
COMMUTATIONS & NETWORKING

SHERATON MEADOWLANDS
NEW JERSEY 2008

CAVELL



new jersey rendez-vous sponsors

welcome



Welcome to the fourth AIRROC/ Cavell Commutations and Networking Event.

Keep this programme with you throughout the event. You should find all the information you need to make your Commutations and Networking event a success.

You will find the timetable on the following pages.

The opening dinner and the event will both be held in the Diamond Court Ballroom on the second floor of the hotel. A break out area will be available in the Derby Room across the hall from the main meeting area. Please see the map on page 9 for the layout of the Sheraton's conference area.

We hope all delegates will attend the dinner on the first evening as it is an ideal way for us to meet as many of you as possible before the hard work begins. **Please let us know if you do not plan to attend, so that we can cater for the correct amount of people.**

We look forward to seeing you.

Special thanks to our Media Sponsor – Insurance Insider

Insurance Insider

new jersey rendez-vous

timetable

All events take place in the Diamond Court Ball Room unless otherwise stated

Monday 20 October 2008	
8.00am	Golf Event
9.30am - 5.00pm	The Mealeys' Educational Session (See page 6 for session timetable) Co chairs of program: Kathy Barker of PRO IS, Inc & Jonathan Bank of Locke, Lord, Bissell & Liddell LLC 5 CLE credits available for attendance
Noon onwards	Registration
Noon - 2.00pm	Welcome Luncheon Guest speaker: Eric Dinallo, Superintendent, New York State Department of Insurance
4.00pm - 5.00pm	AIRROC Annual Board Members Meeting (open to AIRROC members)
6.00pm - 7.30pm	Cocktail Reception
7.30pm - 9.30pm	AIRROC/Cavell Opening Dinner including 'Run-Off Person of the Year'
9.30pm - 11.00pm	After Dinner Drinks
11.00pm onwards	Cash Bar

new jersey rendez-vous

timetable

Tuesday 21 October 2008	
7.30am - 9.30am	Breakfast
7.30am - 5.00pm	Commutation Negotiations/Networking
Noon - 2.00pm	Lunch
5.30pm - 8.00pm	Cocktail Reception
8.00pm - 10.00pm	Casino Night
10.00pm onwards	Cash Bar

Wednesday 22 October 2008	
7.30am - 9.30am	Breakfast
7.30am - 5.00pm	Commutation Negotiations/Networking
Noon - 2.00pm	Lunch
6.15pm - 10.30pm	Dinner Cruise around Manhattan (Please note coaches will depart from 5.30/5.45pm We will cruise at 7.00pm)

Dress Code:

Opening dinner - Lounge suits

During the rest of the event - Business casual

For more details on the topics and speakers, please refer to either www.commutations-rendezvous.co.uk or www.airroc.org

new jersey rendez-vous

mealey's educational sessions

Monday 20 October 2008

- 9.30am** Introductory remarks
- 9.40am** Liability & Risk Exposures in Connection with Subprime-Related Litigation
with Mary Pat Cormier, Alan Kildow & Timothy Stalker
- 11.00am** Regulatory Approach to Liquidation
with Mike Walker, David Brietling & Bruce Shulan
- 12 noon** Luncheon & Keynote Address
with Eric Dinallo
- 1.15pm** Ceding Policy Buy-Backs & Commutations
with Gail Goering, Andrew Maneval, Marvin Mohn & James Sion
- 2.15pm** Afternoon Break
- 2.30pm** Part VII Transfer – Equitas / Resolute Update
with Dan Schwarzmann, Claire Swirski & Robert Romano
- 3.30pm** Purchase and Sale of Reinsurance Recoverables
with Larry Schiffer, Steve Ryland & Jim Moran
- 4.45pm** Adjourn



sheraton meadowlands

about the hotel



The Sheraton Meadowlands Hotel & Conference Center is conveniently located eight miles from Midtown Manhattan (NYC). Nestled in the heart of the Meadowlands area, we are also only 15 minutes from Newark Liberty Airport (EWR).

conference centre floor plans

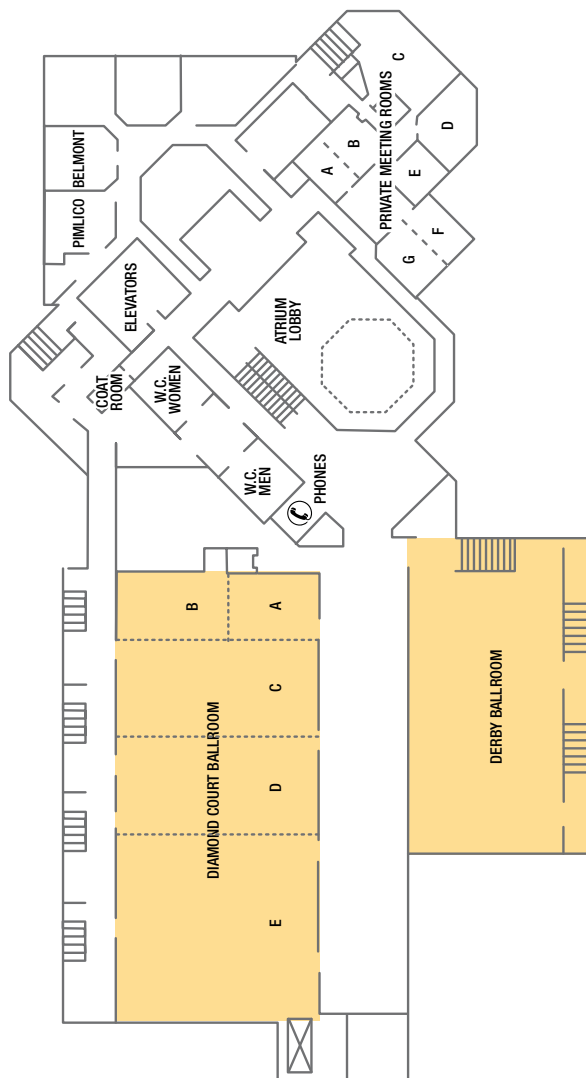

second floor

sheraton meadowlands

complimentary shuttle schedule

transport to and from the hotel

Hotel complimentary shuttle schedule

Daily service, including Saturday and Sunday, to Harmon Cove Outlets, The Plaza, Mill Creek Mall and Secaucus Plaza (NYC bus and Transfers).

Please schedule in advance your pick-up time, listed below, with the hotel reception desk. The hotel does not guarantee pick-ups unless requested at the scheduled times listed below.

Departure Time

9:00am / 10:00am / 11:00am / 1:00pm / 2:00pm / 4:00pm / 6:00pm / 7:30pm / 9:30pm / 10:30pm

Pick-up Time

9:15am / 10:15am / 11:15am / 1:15pm / 2:15pm / 4:15pm / 6:15pm / 7:45pm / 9:45pm / 10:45pm

Airport directions

Airport to hotel

Directions from Newark airport - take NJ turnpike to exit 16W, follow sign to RT.3 E (service road). follow signs for Sheraton Plaza Drive.

Directions from Laguardia airport - take Grand Central Parkway to the Triboro Bridge to Major Deegan Expressway to George Washington Bridge. take NJ turnpike South to exit 16W, follow sign to RT.3 E (service road). follow sign to Sheraton Plaza Drive.

Directions from J.F.K. airport - take Van Wyck expressway to Grand Central Parkway to the Triboro Bridge to Major Deegan expressway to George Washington Bridge. Take NJ turnpike South to exit 16W, follow sign to RT.3 E (service road). follow sign to Sheraton Plaza Drive.

Hotel to airport

Directions to Newark airport - out parking lot and turn right onto RT.3 W to NJ turnpike. Take NJ turnpike South to exit 14 A, B, C. follow signs for Newark airport.

Directions to Laguardia airport - out parking lot and turn right to RT.3 W to NJ turnpike north to George Washington Bridge. take bridge to Harlem River Drive (Harlem River Drive becomes East River Drive) to Triboro Bridge. Bear right to the Grand Central Parkway. Follow signs for Laguardia airport.

Directions to J.F.K. airport - out parking lot and turn right to RT.3 W to NJ turnpike South to exit 13 to Goethals Bridge (toll). take bridge to Staten Island expressway to Verrazano Narrows Bridge (toll) to Belt Shore Parkway to JFK airport.



new jersey rendez-vous

travelling guide to NYC



If you are traveling during the weekdays not at night or the middle of the day please refer to Academy Bus lines bus number 322 schedule. This is a very limited work commuter schedule.*

If you are traveling on the weekends, at night or during the middle of the day please refer to NJ Transit bus number 190 schedule. You will need to also refer to the hotel shuttle bus service schedule. The 190 will leave you at Secaucus Plaza where you will need to schedule a drop off/pick up with the hotel driver.*

Once you have arrived in NYC you will be at the Port Authority located between 8th and 9th Avenues and 40th and 42nd Streets. Located in the Port are the following subways: A,C,E (blue), S (gray), 1, 2, 3 (red), 7 (purple), N, R, Q, (yellow).

In order to cross town from West to East and back again you may take the S (shuttle train) or the 7 to Grand Central Station. If you remain on the 7 you will go to Queens. You may also take the M42, or M104 busses located on 42nd Street.

popular neighborhoods

where they are and how to get there via the MTA

Chinatown - Esp. between E Broadway, Canal St, and Centre St, Manhattan

Subway Services: J, M, Z, N, R, 6 to Canal St; B, D, Q to Grand St; F to East Broadway

Bus Services: M9, M15, M22, M103, B39, B51

Greenwich Village - 14 St to Houston St east and west of Washington Sq, Manhattan

Subway Services: A, C, E, F, S, V to W4 St; 1, 2 to Christopher St; N, R to 8 St; 6 to Astor Pl

Bus Services: M1, M2, M3, M5, M6, M8, M9, M10, M11, M14, M21, M101, M102, M103

Harlem - North of 110 St, Manhattan

Subway Services: A, B, C, D, 1, 2, 3, 4, 5, 6 to 125 St

Bus Services: M1, M2, M3, M4, M5, M7, M10, M11, M18, M60, M100, M101, M102, M103, M104, M116, Bx6, Bx15, Bx19, Bx33

Little Italy - Esp. along Mulberry St, btwn Broome and Canal Sts, Manhattan

Subway Services: J, M, Z, N, R, 6 to Canal St; B, D, Q to Grand St

Bus Services: M1, M103, B39, B51

SoHo - Between Houston and Canal Sts, Lafayette St and Av of Americas, Manhattan

This trendy historic district is the greatest concentration of cast-iron architecture in the U.S. and vibrant home to art galleries, restaurants and shops.

Subway Services: F, S, V to Broadway-Lafayette; 6, C, E to Spring St; N, R to Prince St

Bus Services: M1, M5, M6, M10, M21, M103

*The front desk has the schedules for the 322, 190 and the hotel shuttle.

new jersey rendez-vous

restaurant guide



restaurant guide

continental

ARTHUR'S LANDING

1 Pershing Rd., Weehawken

☎ (201) 867-0777

Directions: Go to the end of the complex. Follow signs to Route 3 East/Lincoln Tunnel. Take the Weehawken/Hoboken exit. (Last exit in New Jersey.) After second light, bear right onto Boulevard East. Make first left onto Baldwin Ave. After passing under railroad trestle, make an immediate left. Arthur's Landing will be approx. 1 mile on the right.

PARK & ORCHARD RESTAURANT

240 Hackensack St., East Rutherford

☎ (201) 939-9292 🌐 www.parkandorchard.com

Directions: Go to the end of the complex. At the STOP sign make a right. Bear right onto Rt. 3 West to Rt. 17 North. At the second light follow semi-circle towards Union Ave. At the next block (Hackensack St.), make a right. The restaurant is on your right.

PEGASUS TRACKSIDE DINING

Meadowlands Racetrack, East Rutherford

☎ (201) 438-3100 🌐 www.meadowlandsracetrack.com

Directions: Go to the end of the complex. At the STOP sign make a right. Bear right onto the overpass to 120 North and take the Racetrack Arena Exit. The restaurant is at the Racetrack. (Not open for lunch.)

GRASSHOPPER

645 Washington Ave., Carlstadt

☎ (201) 460-7771

Directions: Go to the end of the complex. At the STOP sign make a right. Bear right onto Rt. 120 North. Stay right and follow Rt. 3 West to Rt. 17 North. Take Rt. 17 North to Polifly Road Exit. Make a left at the second light.

STONY HILL INN

231 Polifly Road, Hackensack

☎ (201) 342-4085 🌐 www.stonyhill.com

Directions: Go to the end of the complex. At the STOP sign make a right. Bear right onto Rt. 120 North. Stay right and follow Rt. 3 West to Rt. 17 North. Take Rt. 17 North to Polifly Road Exit. Make a left at the second light.

REDDS

317 Washington Ave., Carlstadt

☎ (201) 933-0015 🌐 www.reddsrestaurant.com

Directions: Go to the end of the complex. At the STOP sign make a right. Bear right to Rt. 120 North. Follow signs for Rt. 503/ Moonachie. Redds is on your right, just past the second overpass.

MANNY'S SPORTS RESTAURANT

110 Moonachie Ave., Moonachie

☎ (201) 939-1244

Directions: Go to the end of complex. At the stop sign make a right. Bear right and follow Rt. 3 West to Rt. 17 North. Take the Moonachie Ave. exit. Make right off exit and follow for about one mile. Manny's is on right.

steakhouses

ARTHUR'S STEAKHOUSE

Corner of Third and Washington Ave., Hoboken

☎ (201) 656-5009 🌐 www.arthurstavern.com

Directions: Go to the end of the complex. At the STOP sign make a right. Bear left onto Rt. 3 East/Lincoln Tunnel. Get off at Hoboken/Weehawken Exit. Proceed to the bottom of the hill and bear right. Go straight to the end and make a left on 14th St. Go three blocks. and make a right onto Washington ave. Follow to 3rd Street. Arthur's will be on the corner.

THE CHART HOUSE

Harbor Blvd., Pier D-T, Weehawken

☎ (201) 348-6628 🌐 www.chart-house.com

Directions: Go to the end of the complex. Follow signs to Route 3 East/Lincoln Tunnel. Take the Weehawken/Hoboken exit. (Last exit in New Jersey.) After second light, bear right onto Boulevard East. Make first left onto Baldwin Ave. After passing under railroad trestle, keep right, The Chart House will be on your left.

MIGNON

72 Park Ave., Rutherford

☎ (201) 896-0202 🌐 www.villagerestaurantgroup.com

Directions: Go to the end of the complex. At the STOP sign make a right. Bear right to Rt. 3 West. Take Rt. 3 West to the Park Ave/Ridge Rd. Exit. At Park Ave. make right and Mignon will be on your left approx. 2 miles down.

RUTH'S CHRIS STEAKHOUSE

1000 Harbor Blvd., Weehawken

☎ (201) 863-5100 🌐 www.ruthschris.com

Directions: Go to the end of the complex. Follow signs to Route 3 East/Lincoln Tunnel. Take the Weehawken/Hoboken exit. (Last exit in New Jersey.) After second light, bear right onto Boulevard East. Make first left onto Baldwin Ave. After passing under railroad trestle, keep right, Ruth's Chris will be on your right.

ALEXUS STEAK HOUSE

955 Valley Road, Clifton, NJ

☎ (973) 746-6600 🌐 www.alexussteakhouse.com

Directions: Go to the end of the complex. At the stop sign make a right. Bear right to Rt. 3 west. Follow Rt. 3 West to Rt. 46 West. Take Valley Road exit. Turn left onto Valley Road. The Alexis Steakhouse will be on your left.

seafood

BONEFISH GRILL

200 Mill Creek Dr., Secaucus

☎ (201) 864-3004 🌐 www.bonefishgrill.com

Directions: Go to the end of the complex. At the STOP sign make a right. Bear left to Rt. 3 East. Get off at the second exit (Secaucus/NJTP South) Service road by the Shell gas station. Follow signs to Harmon Meadow Blvd. Go to the end of the Blvd. and make a left. Bonefish will be on your left, across from Mill Creek.

SEA SHACK

293 Polifly Road, Hackensack

☎ (201) 489-7232 🌐 www.seashack.com

Directions: Go to the end of the complex. At the STOP sign make a right. Bear right to Rt. 3 West. Take Rt. 17 North to Polifly Road Exit. After the first light, the restaurant will be on the left side.

italian

BARELI'S

Rt. 3 East Service Rd., Secaucus

☎ (201) 865-2766 🌐 www.barelis.com

Directions: Go to the end of the complex. At the STOP sign make a right. Bear left to Rt. 3 East. Get off at the second exit (Secaucus/NJTP South) Service road by the Shell gas station. Bareli's will be on your right.

GIANNA'S

843 Washington Ave., Carlstadt

☎ (201) 460-7997 🌐 www.giannas.biz

Directions: Go to the end of the complex. At the STOP sign make a right. Bear right to Rt. 3 West. Stay to your left towards Rt. 503/Moonachie. Gianna's will be 1 mile north on your right side.

IL VILLAGGIO

651 Rt. 17 North, Carlstadt

☎ (201) 935-7733 🌐 www.ilvillaggio.com

Directions: Go to the end of the complex. At the STOP sign make a right. Bear right to Rt. 3 West. Take Rt. 3 West to Rt. 17 North. Follow Rt.17 North and Il Villaggio will be on your right about 5 minutes up the road.

PAISANO'S

132 Park Ave., Rutherford

☎ (201) 935-5755 🌐 www.paisanos.com

Directions: Go to the end of the complex. At the STOP sign make a right. Bear right to Rt. 3 West. Take Rt. 3 West to the Park Ave/Ridge Rd. Exit. Turn right onto Park Ave. Paisano's will be on your right approx. 1_ miles up.

TRILLO'S

10 Meadowlands Parkway, Secaucus

☎ (201) 348-1443

Directions: Go to the end of the complex. At the STOP sign make a right. Bear left towards Rt. 3 East and take the first exit, Meadowlands Parkway. At the traffic light, turn right onto Meadowlands Parkway, make first right at Wood Ave.

THE RISOTTO HOUSE

88 Park Ave., Rutherford (Dress Casual)

☎ (201) 438-5344

Directions: Go to the end of the complex. At the STOP sign make a right. Bear right to Rt. 3 West, Take Rt. 3 West to Park Ave/Ridge Rd. exit. At Park Ave. make right go up approx. 2 miles. Make right onto Park Ave half block in The Risotto House on your left.

JERRY'S

340 Paterson Ave., East Rutherford (Dress Casual)

☎ (201) 438-9617

Directions: Go to the end of the complex. At the STOP sign make a right. Bear right for Rt. 120 North. Continue on Rt. 120 North and cross over Rt. 17. At the light (Hackensack St.) go straight about 4 blocks, Jerry's will be on the left.

VILLAGE GOURMET

75 Park Ave., Rutherford (Dress Casual)

☎ (201) 438-9404 🌐 www.villagerestaurant

Directions: Go to the end of the complex. At the Stop sign make a right. Bear right to Rt. 3 West. Take Rt. 3 West to the Park Ave/Ridge Rd. Exit. Turn right onto Park Ave. The Village Gourmet will be approx. 2 miles up on your right.

spanish

DON PEPE

844 McCarter Highway, Newark

☎ (973) 623-4662 🌐 www.donpeperestaurant.com

Directions: Go to the end of the complex. At the STOP sign make a right. Bear right to Rt. 3 West to Rt. 21 South (McCarter Highway). Follow Rt. 21 South to Newark. Don Pepe will be on your left, across from the Hilton Hotel.

BARCELONA

1807 45th St, North Bergen NJ 07047

☎ (201) 330-0990

Directions: Go to the end of the complex. At the STOP sign make a right. Bear right to Rt. 3 East go straight to ramp N Bergen Merge onto Patterson Plank Road, Turn Left onto US 1-9 North 5 blocks on your right.

IBERIA PENINSULA

82-84 Ferry St., Newark

☎ (973) 344- 5611 🌐 www.iberiarestaurants.com

Directions: Go to the end of the complex. At the STOP sign make a right. Bear left to Rt. 3 East. Take second exit for Secaucus/NJ Turnpike South. Exit on 15E (Raymond Blvd.). Take Raymond Blvd for about 2 miles and turn right onto Jefferson St. Go to the first light, make a right and Iberia will be on that street.

SEGOVIA

150 Moonachie Rd., Moonachie

☎ (201) 641-4266 🌐 www.segoviarestaurant.com

Directions: Go to the end of the complex. At the STOP sign make a right. Bear right to Rt. 3 West and bear left towards Rt. 503/ Moonachie. Segovia will be on your left.

thai

BANGKOK CITY THAI RESTAURANT

335 Washington St., Hoboken

☎ (201) 792-6613

Directions: Go to the end of the complex. At the STOP make a right. Bear left to Rt. 3 East to Hoboken/Weehawken Exit. Go to the bottom of the hill, bearing right. Go straight ahead and make a left on 14th St. Go three blocks to Washington Ave. and make a right.

SPRING GRILL

4 Glen Road, Rutherford

☎ (201) 933-4143 🌐 www.springgrill.com

Directions: Go to the end of the complex. At the STOP sign make a right. Bear right to Rt. 3 West. Take Rutherford/Service Rd exit. Bear Right onto the service road, make left follow road up to traffic light make right onto Orient Road approx the sixth block is Glen Road make left go in the middle of block and Spring Grill is on left.

indian

MAHARANI

2151 Lemoine Ave., Fort Lee

☎ (201) 585-8226 🌐 www.maharani.ws

Directions: Go to the end of the complex. At the STOP sign make a right. Bear left to Rt. 3 East and take the 3rd Exit for NJ Turnpike North. Follow it to Rt. 46 East. Take it to Fort Lee Lemoine Ave. Exit. Make a left onto Lemoine Ave. and the restaurant will be on the left side.

TADKA

1297 Paterson Plank Road, Secaucus (Delivery available)

☎ (201) 770-1919 🌐 www.tadkanj.com

Directions: Go to the end of the complex. At the STOP sign make a right. Bear left to Rt. 3 East and take the 2nd exit (Secaucus/ NJ Turnpike). Turn right onto Plaza Ctr. (Sunoco on corner). At second light, turn right. Tadka will be on your left.

chinese

HUNAN GARDEN

33 Ridge Road, Lyndhurst

☎ (201) 939-4567

Directions: Go to the end of the complex. At the Stop sign make a right. Bear right to Rt. 3 West. Take Rt. 3 West to the Park Ave/Ridge Rd. Exit. Turn left onto Ridge Rd.

NEW CHINA INN

32 Ames Ave., Rutherford

☎ (201) 438-0324

Directions: Go to the end of the complex. At the STOP sign make a right. Bear right to Rt. 3 West. Take Rt. 3W to the Park Ave/ Ridge Rd. Exit. At Park Ave. make right and go down to Ames Ave, and then make a left. Rest. On right.

new jersey rendez-vous

restaurant guide

notes

CHINA CHEF

1322 Paterson Plank Road, Secaucus, NJ
☎ (201) 348-6386 🌐 www.chinachef.com

Directions: Go to the end of the complex. At the STOP sign make a right. Bear left to Rt. 3 East. Get off at the second exit (Secaucus/NJTP South) Service road by the Shell gas station. Turn right onto Plaza Center. At first light, turn right onto Paterson Plank Rd. China Chef will be on your right.

japanese

MOUNT FUJI STEAKHOUSE

Rt. 17 South, Hasbrouck Heights
☎ (201) 288-2800 🌐 www.mtfujirestaurants.com

Directions: Go to the end of the complex. At the STOP sign make a right. Bear right to Rt. 3 West. Follow 17 North. Make a “U” turn on Franklin St. Mt. Fuji is on the right side immediately after making the “U” turn.

DARUMA

324 Park Ave Rutherford
☎ (201) 507-9066

Directions: Go to the end of the complex. At the STOP sign make a right. Bear right to Rt. 3 West. Take Rt. 3W to the Park Ave/ Ridge Road Exit. Turn Right onto Park Ave. Continue on Park Ave. for approx. 2 miles, Daruma will be on your right.

CAVELL

Cavell 9-13 Fenchurch Buildings,
London EC3M 5HR England
tel +44 (0)845 0555 450 fax +44 (0)20 7780 5851
www.commutations-rendezvous.com



Association of Insurance and
Reinsurance Run-off Companies
www.airroc.org